

The product is a component of 3D printing solutions. The UV device outputs steady, focused and consistent UV lights to cure the printouts printed with photopolymer resins in a short period. The post curing process increases the hardness and durability of the printed products.

## Unpacking

After removing all packing materials, open the cover door and peel off the protection films from the reflective sheets.

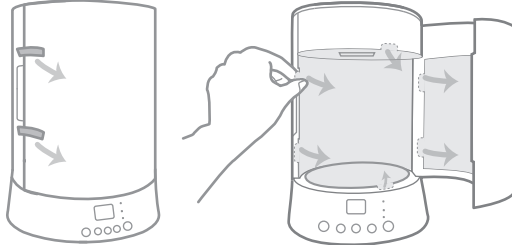

\*Please retain all original packaging material that came with the product. If warranty service is needed, please ship your product with the original packaging. Shipping without the original packaging material may cause product damage during the shipment and may result in additional service fees for which you shall be solely responsible.

## Package contents

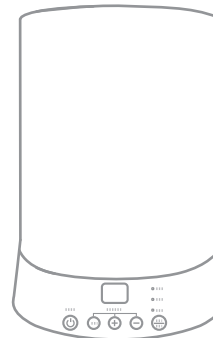

The curing unit

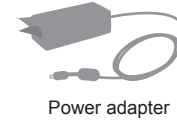

Power adapter



Power cord

## Components

[Back view]

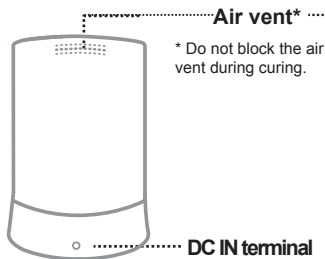

\*Do not block the air vent during curing.

[Front view]

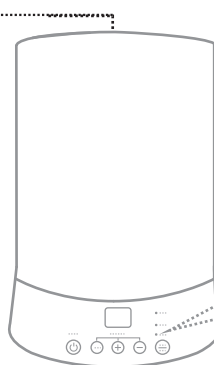

[Interior]

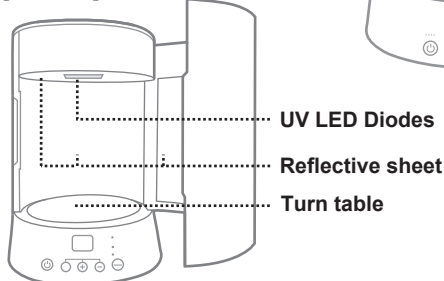

### Operation panel

Display showing the power level, curing time or turn table configuration. When curing is in progress, the display switches to a countdown timer.

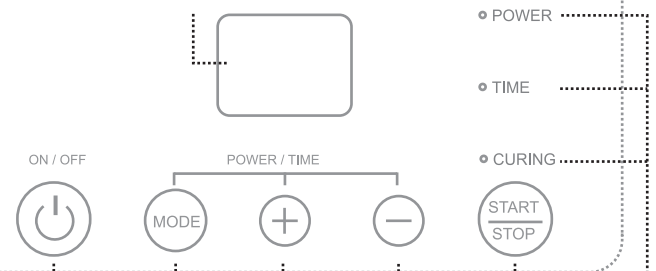

Power button: press and hold the button to power on or off the device.

Starts curing. Curing is stopped after this button is pressed during curing.

Click to switch between the power level, curing time or turn table configuration.

Increase/decrease the power level, curing time or turn table. Activate/deactivate turn table.

## Safety / Operation Notices

- The glass cover of UV LED diodes becomes hot after curing. Avoid touching it.
- After curing, the objects are hot. The heat from the UV unit does not affect the quality of the objects.
- The product is used to cure objects printed with photopolymer resin. Do not heat other objects.
- Use only the power cord and power adapter included with the product. Using a different power cord or adapter may cause equipment malfunction or injury to the user.
- The product has been designed with safety first. Curing stops automatically when the cover door is opened. Do not disassemble the product as it may disable the security protection. This can cause eye damage from exposure to ultraviolet rays. The guarantee will be void.
- The device has been designed for professional use, not for home use.

## LED indicator

The LED lights indicate the status of the curing chamber. To switch setup item, press [MODE] button.

- POWER** LED will light when switched to curing power level setup. To adjust, click [+] or [-].
 

Intensity 01	■□□
Intensity 02	■□■
Intensity 03	■□■
- TIME** LED will light when switched to curing timer setup. Curing timer with range from 1 to 60 minutes. Adjust by 1 minute intervals, click [+] or [-]. Adjust by 5 minutes intervals, keep pressing [+] or [-].
- POWER + TIME** LEDs will light when switched to turntable mode. To set the turn table, click [+] or [-].
  - Set 00 - Turn table deactivated (This setting allows to cure without noise. You can also disable the turntable if the object is too large and does not fit on it).
  - Set 01 - Turn table activated (This setting offers superior curing efficiency).
- CURING** Lit when curing is in progress. The LED blinks when curing is paused (as happens when the cover door is opened).

## How to perform UV curing

- Connect the curing chamber to the power source.

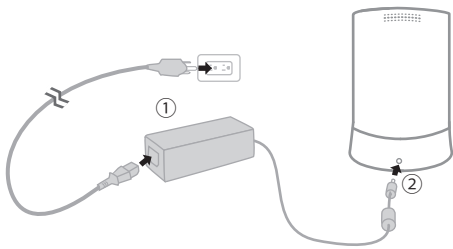

- ① Insert the power cord into the power adapter and plug the other end into a power outlet.
- ② Connect the power adapter to the curing chamber's DC input terminal located at the rear.

- Open the cover door, place the UV resin printed object on the turntable and close the door.

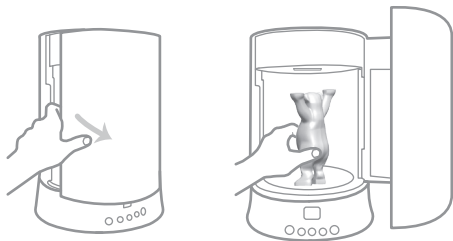

- Press the power button to power the device.



- Adjust the intensity of the curing power, timer, and turntable based on the characteristics of the printed object.

- ① Press to change the setting mode.

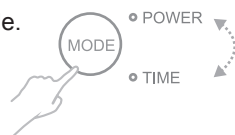

- ② Press to adjust power level or curing time, or turn turntable on/off.



- ③ Press to start curing.



## Maintenance

- Check that the reflective sheets and the glass cover of the UV LED diodes are clean.
  - Use a lint-free cloth to wipe off any resin or alcohol before curing begins.



**MESTRA**®

Talleres Mestraitua S.L.  
Txori-erri Etorbidea, 60  
T: (+34) 944530388 - F: (+34)944711725  
info@mestra.es - www.mestra.es  
48150 SONDIKA - BILBAO - SPAIN

## Product specifications

Model number	3UD10
Light source	UV LED $\lambda$ 385 nm
Max. curing size	$\varnothing$ 180 x H200 mm
Max. load	1,5 kg
LED UV power	16 W
Power supply	Entrada CC de 24 V 2,5 A
Operation conditions	Temperature: 10-35 °C /50-95 °F Humidity: 40-80% RH (without condensation)

## Curing guidelines

- Make sure resin printed objects are clean:
  - Thoroughly wash printed objects with alcohol.
  - Leave the printed objects until the alcohol evaporates from their surface.
- To achieve maximum curing efficiency:
  - Place the object in the center of the turntable.
  - Make sure that the largest possible area of the object is facing the top LEDs.
  - In the case of large objects, you can incinerate it on the curing stand.
  - Elevate small items with the stand to get them closer to the UV LEDs.

### Curing efficiency

Higher

Normal

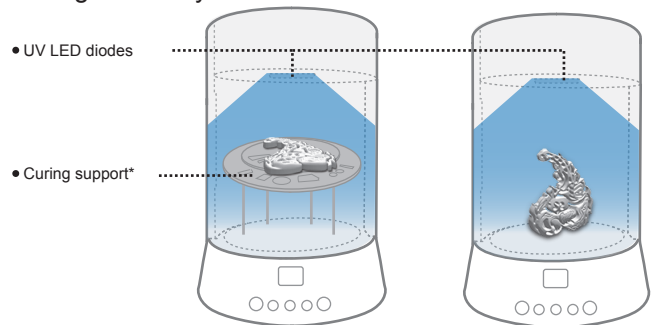

### Note

\*You can use any object as a support or download the 3D model: <https://mestra.es/wp-content/uploads/2020/02/Soportezip>  
Download the 3D models of the curing stand and print them.

- Rotate the item periodically to allow it to fully cure.

Curing stops when the cover door is opened.  
So you can adjust the position of the object at any time.  
To resume curing you just have to close the door.

- Recommended cure settings:

For general purpose resins, we recommend a power level of 03 and a time of 10 minutes.

- Objects imprinted with clear or white resin may turn yellow after curing.
- If resin-based impressions are over-cured, the yellow cast will increase.
- Be sure to rotate the item and start the curing process again to ensure that the item is fully healed.