

# MESTRA®

MINI BOX DE PULIDO  
MINI POLISHING BOX  
MINI BOX DE POLISSAGE  
Ref. 080508

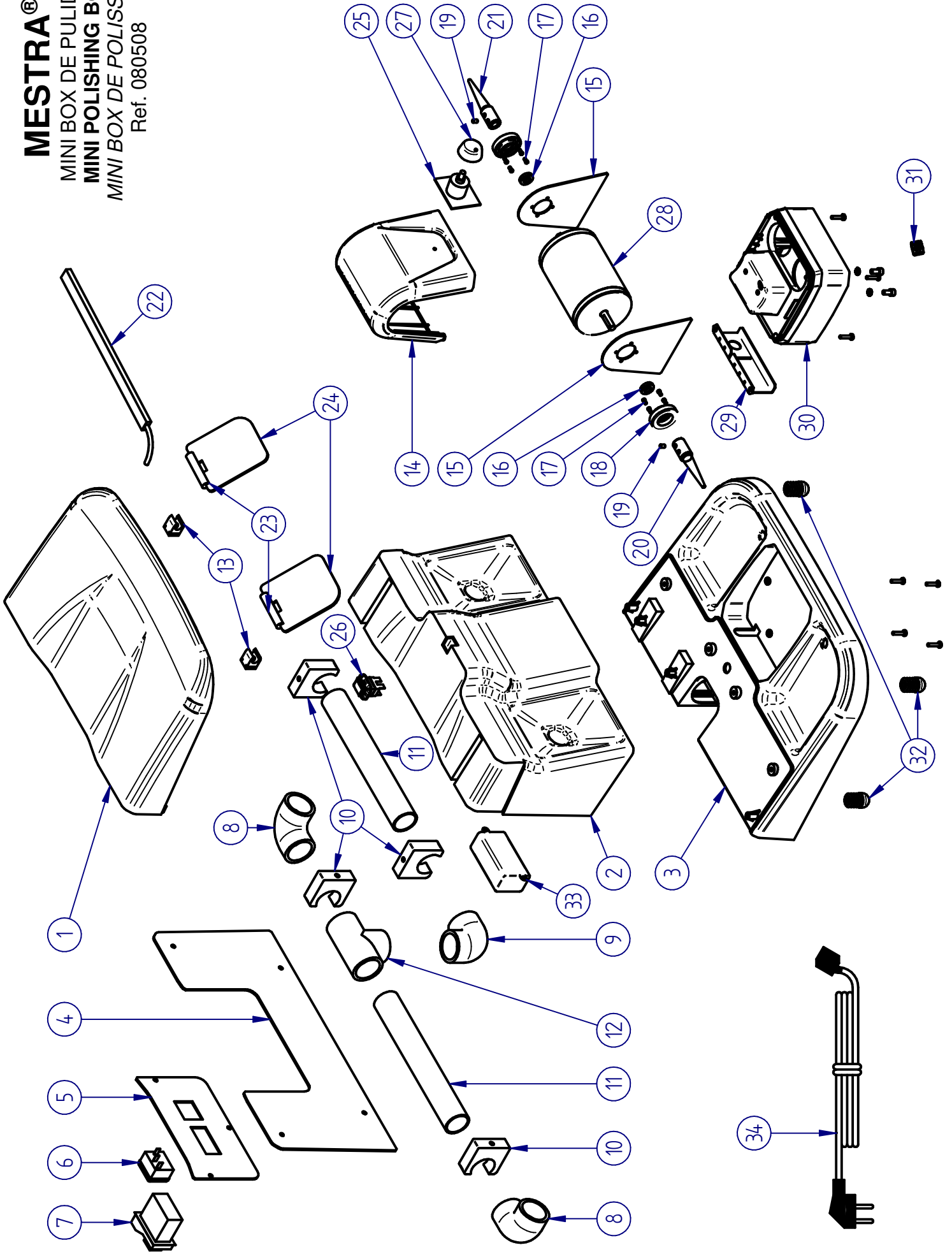

**MESTRA®**  
**MINI POLISHING BOX**  
**"GORBEA"**  
 Ref. 080508

| Nº | Ref.      | DESCRIPCIÓN                    | DESCRIPTION         |
|----|-----------|--------------------------------|---------------------|
| 1  | 080508-01 | Tapa superior                  | Upper housing       |
| 2  | 080508-02 | Fondo carcasa                  | Back housing        |
| 3  | 080508-03 | Base de carcasa                | Lower housing       |
| 4  | 080508-04 | Chapa de fondo                 | Back lid            |
| 5  | 080508-05 | Chapa para interruptor         | Switch lid          |
| 6  | 080490-06 | Base de conexión               | Socket              |
| 7  | 080080-40 | Interruptor                    | Safe switch         |
| 8  | 080508-08 | Codo hembra-hembra             | Elbow female-female |
| 9  | 080508-07 | Codo macho-hembra              | Elbow male-female   |
| 10 | 080508-10 | Pinzas                         | Pipe clamp          |
| 11 | 080614-16 | Tubo de aspiración             | Pipe                |
| 12 | 080508-09 | Derivación T                   | Fork                |
| 13 | 080253-02 | Abrazaderas                    | Hinge clamp         |
| 14 | 080164-01 | Carcasa mini pulidora          | Motor upper housing |
| 15 | 080164-05 | Chapa lateral mini pulidora    | Motor lid           |
| 16 | 080164-07 | Fieltro                        | Felt                |
| 17 | 080590-51 | Tornillos para fieltros        | Felt bolt           |
| 18 | 080164-03 | Porta fieltros                 | Felt holder         |
| 19 | 080164-11 | Espárragos porta cepillos      | Brush holder bolt   |
| 20 | 100277-01 | Porta cepillos izquierdo       | Left brush holder   |
| 21 | 100277-02 | Porta cepillos derecho         | Right brush holder  |
| 22 | 080508-15 | Lámpara Led                    | Led bar             |
| 23 | 080508-13 | Eje pantallas protectoras      | Shield shaft        |
| 24 | 080508-16 | Pantallas protectoras          | Shield              |
| 25 | 080164-15 | Tarjeta electrónica pulidora   | Electronic card     |
| 26 | 080422-17 | Interruptor luz                | Light switch        |
| 27 | 080164-06 | Pomo de tarjeta electrónica    | Knob                |
| 28 | 080164-08 | Motor mini pulidora            | Motor               |
| 29 | 080508-12 | Chapa porta cable base         | Base cable holder   |
| 30 | 080164-02 | Carcasa inferior mini pulidora | Motor lower housing |
| 31 | 080508-21 | Regleta                        | Connection strip    |
| 32 | 080508-18 | Patas                          | Leg                 |
| 33 | 080614-20 | Fuente de alimentación         | Power source        |
| 34 | 000250    | Cable                          | Cord                |